



ADDENDUM TO SOLICITATION/OFFER AND AWARD

1. ADDENDUM 1	2. EFFECTIVE DATE 5/23/17	3. SOLICITATION NUMBER RFQ 17-4	4. SOLICITATION DESCRIPTION Levy Kitchen Equipment
5. ISSUED BY: Steward E. Trautman, Jr., Director of Purchasing Founders Hall / Room 109 3001 SW College Road Ocala, FL 34424 TELEPHONE: (352) 854-2322 ext. 1227 FAX: (352) 291-4423		6. MAIL TO: COMPANY NAME: CONTACT: COMPANY ADDRESS: TELEPHONE:	

7. TYPE OF ACTION REQUESTED

Check one:

- A. THE CHANGE ORDER IS ISSUED TO INCREASE/DECREASE FUNDING AMOUNT AS SET FORTH IN ITEM 8 BELOW:
- B. THE ABOVE NUMBERED SOLICITATION IS MODIFIED TO REFLECT THE ADMINISTRATIVE CHANGES SET FORTH IN ITEM 8 BELOW:
- C. OTHER (Set forth in Item 8 below)

IMPORTANT: BIDDER IS NOT IS REQUIRED TO SIGN THIS DOCUMENT AND RETURN ___ ORIGINAL SIGNED COPY(IES) TO THE ISSUING OFFICE.

8. DESCRIPTION OF ADDENDUM:

<p>1. Questions and responses is attached regarding specifications.</p> <p>2. Drawing of work tables is attached.</p>

9. AUTHORIZED SIGNATURES REQUIRED

_____ NAME (PRINT)	_____ TITLE	<u>Stewart E. Trautman, Jr.</u> NAME (PRINT)	<u>Director of Purchasing</u> TITLE
_____ SIGNATURE	_____ DATE SIGNED	_____ SIGNATURE	_____ DATE SIGNED

Questions and responses:

Q - Panasonic model number is not valid. It has been replaced with NE-1025F.

R – **NE-1025F has been review and approved.**

Q - Traulsen: need voltage, door hinging, any additional or change out for tray slides/shelves, standard legs or optional casters?

R - need voltage: **208V**

R - door hinging: **Please provide 1 left and 1 right.**

R - any additional or change out for tray slides/shelves: **No Additions, No Changes**

R - standard legs or optional casters: **Standard Legs**

Q - Blodgett: note says stacked on Zephaire-E. Is that unit existing? Need voltage. Included a water filter?

R - note says stacked on Zephaire-E. Is that unit existing? **No, I assumed it was the base for the oven.**

R - Need voltage: **3P/208V**

R - Included a water filter? **No**

Q - Hobart: With or without booster heater? Gas or electric heat (electric is standard)? Voltage? Suggested water hammer arrestor kit? Tables: With or without back splash -if with - splash height. Undershelf? Legs/undershelf galvanized or stainless?

R - With or without booster heater? **Yes W/ booster heater**

R - Gas or electric heat (electric is standard)? **Electric**

R - Voltage? **3P/208V**

R - Suggested water hammer arrestor kit? **Yes, please provide.**

R - Tables: With or without back splash -if with - splash height. **Yes, 6" back splash**

R - Undershelf? **Yes**

R - Legs/undershelf galvanized or stainless? **Stainless Steel**

Q - Advance: Model number incorrect. I believe it should be K7-CS-21. Faucet? Faucet 8",

12",14", 16" . Drains? Twist or lever? If lever waste, with or without overflow.

R - Model number incorrect. I believe it should be K7-CS-21. **K7-CS-21 has been approved**

R - Faucet? **Yes**

R - Faucet 8",12",14", 16": **16"**

R - Drains? Twist or lever? **Lever**

R - If lever waste, with or without overflow. **With Overflow**

Q - Eagle: Just confirming that you want galvanized undershelf and legs vs stainless.

R – **Stainless Steel**

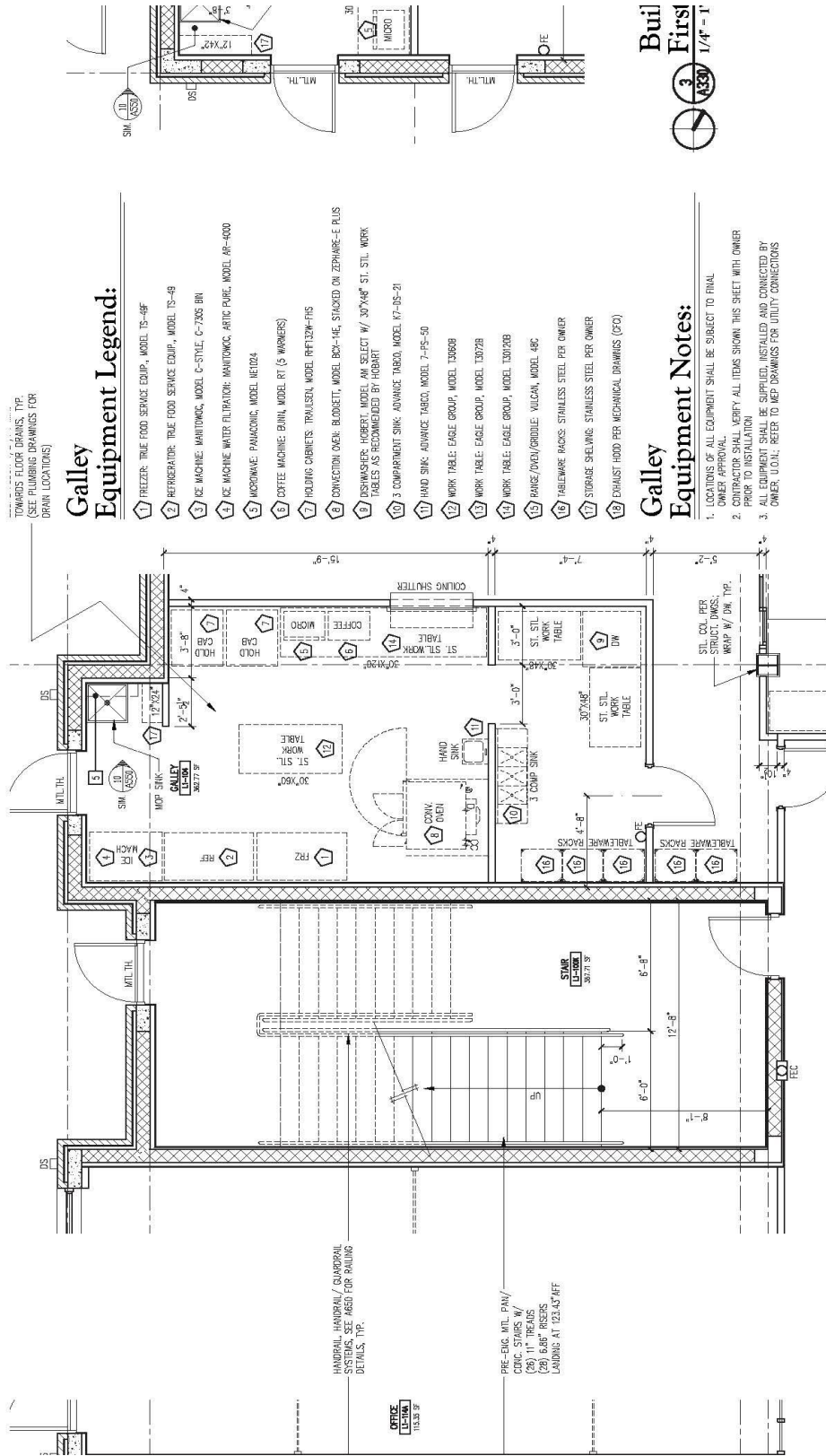

TOWARDS FLOOR DRAINS, TYP.
(SEE PLUMBING DRAWINGS FOR
DRAIN LOCATIONS)

Galley Equipment Legend:

- 1 REFRIG. TRUE FOOD SERVICE EQUIP., MODEL TS-48F
- 2 REFRIGERATOR: TRUE FOOD SERVICE EQUIP., MODEL TS-48
- 3 ICE MACHINE: MAINTOMAC, ARTIC PURE, MODEL AR-4000
- 4 ICE MACHINE WATER FILTRATOR: MAINTOMAC, ARTIC PURE, MODEL AR-4000
- 5 MICROWAVE: PANASONIC, MODEL N1204
- 6 COFFEE MACHINE: BUNN, MODEL RT (5 WARMERS)
- 7 HOLDING CABINETS: TRULIGN, MODEL RPT27M-FHS
- 8 CONNECTION OVEN: BLODGETT, MODEL BCG-14E, STACKED ON ZEPHYRUS-E PLUS
- 9 DISHWASHER: HERBERT, MODEL AM SELECT W/ 307X48" ST. STL. WORK TABLES AS RECOMMENDED BY HOBART
- 10 2 COMPARTMENT SINK: ADVANCE TABLE, MODEL K7-DS-21
- 11 HAND SINK: ADVANCE TABLE, MODEL 7-PS-50
- 12 WORK TABLE: EAGLE GROUP, MODEL T3068B
- 13 WORK TABLE: EAGLE GROUP, MODEL T3072B
- 14 WORK TABLE: EAGLE GROUP, MODEL T3012B
- 15 RANGE/OVEN/GRODLE: VULCAN, MODEL 48C
- 16 TABLEWARE RACKS: STAINLESS STEEL PER OWNER
- 17 STORAGE SHELVING: STAINLESS STEEL PER OWNER
- 18 EXHAUST HOOD PER MECHANICAL DRAWINGS (CFC)

Galley Equipment Notes:

- 1. LOCATIONS OF ALL EQUIPMENT SHALL BE SUBJECT TO FINAL OWNER APPROVAL
- 2. CONTRACTOR SHALL VERIFY ALL ITEMS SHOWN THIS SHEET WITH OWNER PRIOR TO INSTALLATION
- 3. ALL EQUIPMENT SHALL BE SUPPLIED, INSTALLED AND CONNECTED BY OWNER. U.O.I.L. REFER TO MEP DRAWINGS FOR UTILITY CONNECTIONS

BUILD
First
3
A330
1/4" = 1'

HANDRAIL, HANDRAIL / GUARDRAIL SYSTEMS SEE A601 FOR RAILING DETAILS, TYP.

PRE-ENG. MTL. PAN/
CODG. STAIRS W/
(26) 11" TREADS
(28) 6.66" RISERS
LANDING AT 123.45' AFF

OFFICE
L1-100A
18.38 SF

STAIR
L1-100B
38.71 SF

GALEY
L1-100C
38.77 SF